

LIVING QUARTERS

CARGO TRAILERS





A



B



C



D



E



F



G



H



**Optional Residential Quality
Hide-A-Bed Couch**



Raised Foot Rest Both Sides



Converts into a Full Queen Sized Bed

- A. The fully equipped kitchen includes all the conveniences.
- B. A handy pantry located next to the refrigerator complements the kitchen and dining area.
- C. The booth dinette includes a 26" x 36" table and converts into a bed for additional sleeping space.
- D. Twin beds with a center night stand are an available option.
- E. The bedroom features an optional entertainment center with a wall-mounted flat screen TV.
- F. The bedroom slide-out increases bedroom space.
- G. Beautiful cabinetry provides an abundance of bedroom storage space (bedroom slide-out model shown).
- H. The 60" x 74" queen bed is flanked by his/her wardrobes and individual reading lights and can be ordered with optional bed spread and pillows.
- I. This optional entertainment center features a free-standing or wall mounted flat screen TV.
- J. The bathroom includes a lighted vanity mirror and medicine chest over the lavatory along with a linen closet.
- K. A Thetford foot flush toilet and roomy shower stall with one-piece tub surround complete the bathroom necessities.

FLOORPLANS

11' Living Quarters

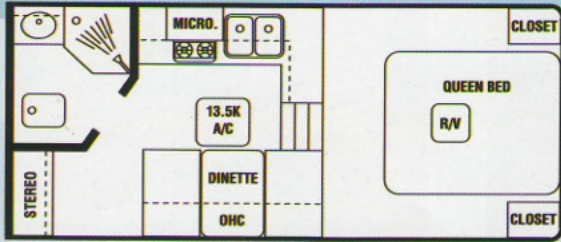

- 27x27 Shower Stall with One-Piece Tub Surround
- Thetford Toilet
- 25" X 18" Stainless Steel Double Sink
- 27 Gallon Fresh Water System
- (2) 27 Gallon Waste Water Tanks
- 2-Burner Gas Range with Lighted Range Hood
- 4 Cubic Ft. Refrigerator (Gas/Electric)
- 0.9 Cubic Ft. Microwave (850 Watts)
- AM/FM/CD/Cassette Stereo with 4 Speakers and Exterior Antenna
- 25,000 BTU Ducted Furnace
- 13,500 BTU Air Conditioner
- Combination Heat and A/C Thermostat
- 6 Gallon Water Heater with DSI (Gas)
- 60x74 Queen Size Bed with Bed Lifter System (Under-Bed Storage)
- 32" RV Door with Window, Screen Door, Deadbolt Lock, and Keys
- Windows with Screens, Valances, Drapes, and Mini-Blinds
- Solid Wood Core with Oak Vinyl-Wrapped Cabinet Construction
- Solid Oak Cabinet Doors
- Dinette Booth with 26x36 Table (Converts Into Bed)
- Velvet Fabric Interior
- Carpet with Pad or Linoleum Flooring
- 12V Powered Bathroom Roof Vent
- 45-Amp Power Center (Dedicated to Living Quarters Power)
- (2) 30lb. LP Gas Bottles with Regulator
- Monitor Panel
- On-Demand Water Pump
- City Water Hookup
- Exterior TV Antenna with (2) Jacks
- LP Gas Leak Detector
- Smoke Detector
- Fire Extinguisher
- Water Heater Bypass for Winterizing
- Tissue Holder and Towel Bar

12' Living Quarters

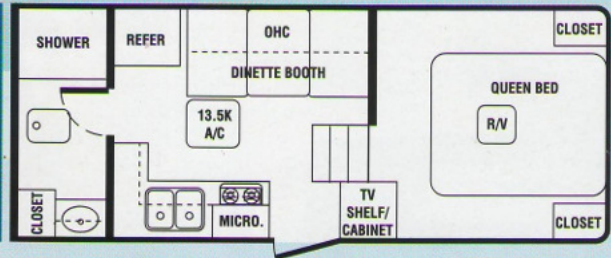

- 27x36 Shower Stall with One-Piece Tub Surround
- Thetford Toilet
- 25" X 18" Stainless Steel Double Sink
- 40 Gallon Fresh Water System
- (2) 27 Gallon Waste Water Tanks
- 2-Burner Gas Range with Lighted Range Hood
- 6 Cubic Ft. Refrigerator (Gas/Electric)
- 0.9 Cubic Ft. Microwave (850 Watts)
- AM/FM/CD/Cassette Stereo with 4 Speakers and Exterior Antenna
- 25,000 BTU Ducted Furnace
- 13,500 BTU Air Conditioner
- Combination Heat and A/C Thermostat
- 6 Gallon Water Heater with DSI (Gas)
- 60x74 Queen Size Bed with Bed Lifter System (Under-Bed Storage)
- 32" RV Door with Window, Screen Door, Deadbolt Lock, and Keys
- Windows with Screens, Valances, Drapes, and Mini-Blinds
- Solid Wood Core with Oak Vinyl-Wrapped Cabinet Construction
- Solid Oak Cabinet Doors
- Dinette Booth with 26x36 Table (Converts Into Bed)
- Velvet Fabric Interior
- Carpet with Pad or Linoleum Flooring
- 12V Powered Bathroom Roof Vent
- 45-Amp Power Center (Dedicated to Living Quarters Power)
- (2) 30lb. LP Gas Bottles with Regulator
- Monitor Panel
- On-Demand Water Pump
- City Water Hookup
- Exterior TV Antenna with (2) Jacks
- LP Gas Leak Detector
- Smoke Detector
- Fire Extinguisher
- Water Heater Bypass for Winterizing
- Tissue Holder and Towel Bar

14' Living Quarters

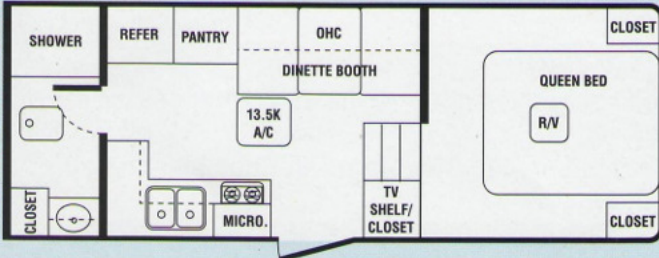

- 27x36 Shower Stall with One-Piece Tub Surround
- Thetford Toilet
- 25" X 18" Stainless Steel Double Sink
- 40 Gallon Fresh Water System
- (2) 27 Gallon Waste Water Tanks
- 2-Burner Gas Range with Lighted Range Hood
- 6 Cubic Ft. Refrigerator (Gas/Electric)
- 0.9 Cubic Ft. Microwave (850 Watts)
- AM/FM/CD/Cassette Stereo with 4 Speakers and Exterior Antenna
- 25,000 BTU Ducted Furnace
- 13,500 BTU Air Conditioner
- Combination Heat and A/C Thermostat
- 6 Gallon Water Heater with DSI (Gas)
- 60x74 Queen Size Bed with Bed Lifter System (Under-Bed Storage)
- 32" RV Door with Window, Screen Door, Deadbolt Lock, and Keys
- Windows with Screens, Valances, Drapes, and Mini-Blinds
- Solid Wood Core with Oak Vinyl-Wrapped Cabinet Construction
- Solid Oak Cabinet Doors
- Dinette Booth with 26x36 Table (Converts Into Bed)
- Pantry Beside Dinette Booth
- Velvet Fabric Interior
- Carpet with Pad or Linoleum Flooring
- 12V Powered Bathroom Roof Vent
- 45-Amp Power Center (Dedicated to Living Quarters Power)
- (2) 30lb. LP Gas Bottles with Regulator
- Monitor Panel
- On-Demand Water Pump
- City Water Hookup
- Exterior TV Antenna with (2) Jacks
- LP Gas Leak Detector
- Smoke Detector
- Fire Extinguisher
- Water Heater Bypass for Winterizing
- Tissue Holder and Towel Bar

14' Living Quarters w/Slide-Out

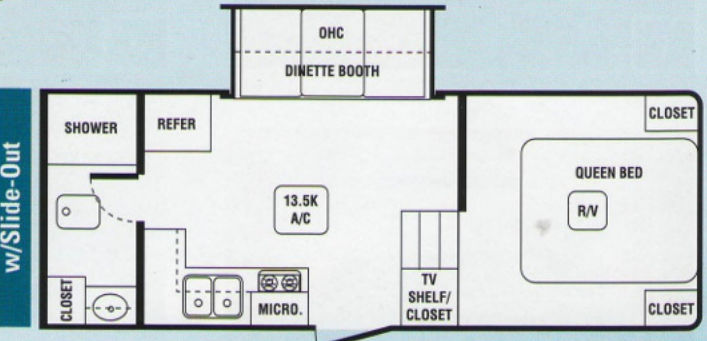

- Slideout Room with Awning Covering
- 27x36 Shower Stall with One-Piece Tub Surround
- Sealand China Toilet
- 25" X 18" Stainless Steel Double Sink
- 40 Gallon Fresh Water System
- (2) 27 Gallon Waste Water Tanks
- 3-Burner Gas Range with Oven and Lighted Range Hood
- 6 Cubic Ft. Refrigerator (Gas/Electric)
- 0.9 Cubic Ft. Microwave (850 Watts)
- Coffee Maker Installed
- Spice Rack
- AM/FM/CD/Cassette Stereo with 4 Speakers and Exterior Antenna
- 25,000 BTU Ducted Furnace
- 13,500 BTU Air Conditioner
- Combination Heat and A/C Thermostat
- 6 Gallon Water Heater with DSI (Gas)
- 60x74 Queen Size Bed with Bed Lifter System (Under-Bed Storage)
- 32" RV Door with Window, Screen Door, Deadbolt Lock and Keys
- Windows with Screens, Valances, Drapes and Mini-Blinds
- Solid Wood Core with Oak Vinyl-Wrapped Cabinet Construction
- Solid Oak Cabinet Doors
- Dinette Booth with 26x36 Table (Converts Into Bed)
- Velvet Fabric Interior
- Carpet with Pad or Linoleum Flooring
- 12V Powered Bathroom Roof Vent
- 45-Amp Power Center (Dedicated to Living Quarters Power)
- (2) 30lb. LP Gas Bottles with Regulator
- Monitor Panel
- On-Demand Water Pump
- City Water Hookup
- Exterior TV Antenna with (2) Jacks
- LP Gas Leak Detector
- Smoke Detector
- Fire Extinguisher
- Water Heater Bypass for Winterizing
- Tissue Holder and Towel Bar
- Magazine Rack

14' Living Quarters w/Dual Slide-Out

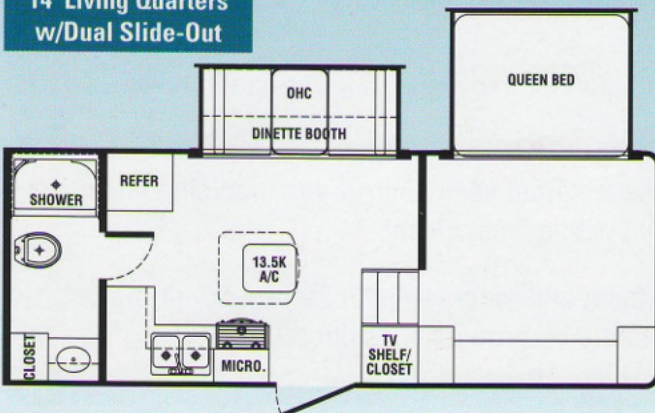

- Slide-Out Room with Awning Covering
- 27" X 36" Shower Stall with One-Piece Tub Surround
- Sealand China Toilet
- 25" X 18" Stainless Steel Double Sink
- 40 Gallon Waste Water Tanks
- 3-Burner Gas Range with Oven and Lighted Range Hood
- 6 Cubic Ft. Refrigerator (Gas/Electric)
- 0.9 Cubic Ft. Microwave (850 Watts)
- Coffee Maker Installed
- Spice Rack
- AM/FM/CD/Cassette Stereo with (4) Speakers and Exterior Antenna
- 25,000 BTU Air Conditioner
- Combination Heat and A/C Thermostat
- 6 Gallon Water Heater with DSI (Gas)
- 60" X 74" Queen Size Bed with Bed Lifter System (Under-Bed Storage)
- 32" RV Door with Window, Screen Door, Deadbolt Lock, and Keys
- Windows with Screens, Valances, Day/Night Shades
- Solid Wood Core with Maple Vinyl-Wrapped Cabinet Construction
- Solid Maple Cabinet Doors
- Dinette Booth with 26" X 36" Table (Converts Into Bed)
- Carpet with Pad or Linoleum Flooring
- 12V Powered Bathroom Roof Vent
- 45-Amp Power Center (Dedicated to Living Quarters Power)
- (2) 30lb. LP Gas Bottles with Regulator
- Monitor Panel
- On-Demand Water Pump
- City Water Hookup
- Exterior TV Antenna with (2) Jacks
- LP Gas Leak Detector
- Smoke Detector
- Fire Extinguisher
- Water Heater Bypass for Winterizing
- Tissue Holder and Towel Bar
- Magazine Rack
- Insulated Floor, Walls, and Ceiling in LQ Area



Optional cabinets in rear cargo area are standard white in color or can be upgraded to colored cabinets or bright anodized.



Optional generator can be installed to provide power where electrical hookup is not available.



The optional entertainment package gives you surround sound on the inside and marine speakers on the exterior as well as exterior TV mount and hookup.

The electric steps automatically fold up and store underneath for transport.

This exterior bracket provides secure mounting for the flat screen TV.

DECOR OPTIONS



Tan Decor



Green Decor



Blue Decor

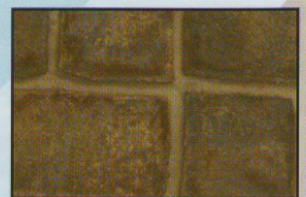

Slate Linoleum

All illustrations and specifications contained in this literature are based on the latest product information at time of publication. Forest River reserves the right to make changes in prices, colors, materials, equipment and specifications at anytime, without notice, and assumes no responsibility for any error in this literature. All units are shipped F.O.B. point of manufacture.

*Exact fabrics may change due to availability.

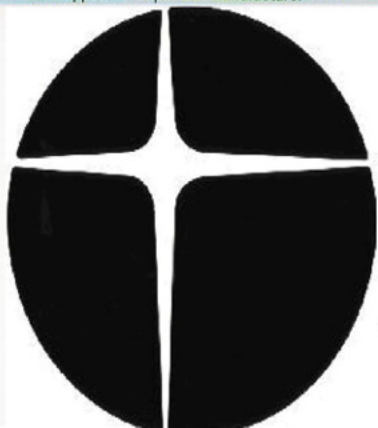

MILLENNIUM TRAILERS

1-800-978-7223

MillTrailers.com